



# ELDORADO

## FIREPLACE SURROUNDS

## Fireplace Surround Installation Instructions

### STANDARD WOOD FRAMING ONLY

Congratulations on selecting an Eldorado Fireplace Surround! Eldorado Fireplace Surrounds have been designed to install in just 5 steps. Please be sure to read through the entire installation instructions in advance of beginning your installation. If you have any questions regarding your Fireplace Surround or installation, please call us at 800.925.1491.

### *Before You Begin...*

#### TOOLS & PRODUCT INVENTORY



#### 1. You will need the following tools for your installation:

- Measuring tape
- 4'-6' level
- 1/4" spacers (for grout joints)
- 4"-4 1/2" grinder with diamond blade or wet tile saw (for cutting hearth stones & riser blocks)
- Drill with screw attachment
- Large caulking gun
- Square
- A bucket of clean water & sponge
- Wood stud finder

#### 2. Items included with your order:

- Mantel & legs
- Trim kit material: 3 panels (3/4" matching material)
- Ledger board and 4" mounting screws
- Large tube of color matched caulking
- 1 1/2" screws for tabs on legs
- Large tube of polyurethane adhesive
- 3 oz bottle of color wash (for touch-ups, if needed)
- Shims
- 3" gold screws for mounting mantel to ledger board

*Step 1***PREPARING THE SURFACE/GAS VALVE LOCATION**

1. If completing a remodel, remove the existing material around your firebox. Make sure the firebox is flush with the surrounding wall. This will ensure a tight installation of the mantel, legs and trim panels to the wall.
2. Take note where the gas valve is located in relation to your fireplace opening. You may need to move this valve to ensure that it is not covered by your fireplace surround.

*Step 2***HEARTH INSTALLATION**

Begin your Fireplace Surround installation with the hearth. If utilizing Eldorado Hearths or Riser Blocks, follow these steps.

1. Select a hearth stone that is no thicker or taller than the distance from the sub flooring to the bottom of the fireplace opening.
2. If a raised hearth is desired, Eldorado hearth risers can be utilized. They are designed of a lightweight material which allows for easy cutting in the field. Hearth risers must be capped with Eldorado hearth stones.



3. Locate the center point of your firebox and mark the wall and floor.
4. Lay the hearth stones out on the floor and determine if any cuts will be needed. Additional center hearths are available to order if your hearth exceeds 72" long.
5. The hearth stones should lay flush with floor. **If they do not lay flush, please make adjustments using the shims provided with your surround.**
6. The hearth stones can be cut using a 4"-4½" diamond or wet saw. (NOTE: If installing hearth riser blocks, please mark with a square and use a 4"-4½" hand held diamond saw to cut to size.)
7. Once the hearth stones have been cut to the correct size, center them underneath your fireplace opening.



**STEP 2: HEARTH INSTALLATION CONTINUED**

8. Trace around each hearth stone using a pencil to create an outline on the floor. Be sure to allow  $\frac{1}{4}$ " for the grout joints. Remove the hearth stones to continue installation.



9. Apply the polyurethane adhesive to the clean, dry, dust-free floor substrate within your trace lines, and ensure that the adhesive is no closer than 2" from where the edge of the hearth stone is desired. Apply liberally to the floor and the back of the hearth stone to be set. Standardize grout joints immediately after setting stones, to ensure adhesive does not set prematurely. (NOTE: To avoid hearth stones from moving when installing surround legs, wait for adhesive to dry.)

*Step 3***LEG INSTALLATION**

Before installing legs, double check fireplace opening left to right. Review the interior dimensions of your fireplace surround. Some Eldorado Surrounds can be adjusted a couple inches to make the interior dimensions smaller. This may be advantageous if you desire to have the legs finish directly to the edge of the vertical lines of the fireplace opening.

1. Using the inside leg dimensions, draw two parallel plumb lines on the wall surface next to the fireplace opening. Confirm that each line is equidistant from the center of the fireplace.
2. Apply polyurethane to the back of the fireplace surround legs.
3. Glue legs in place along parallel pencil lines. Secure the top of the leg with the provided  $1\frac{1}{2}$ " screws through tabs located at the top of the leg. The screws are intended to hold the legs in place until the adhesive cures. NOTE: Make sure the tabs do not interfere with the mantel, by positioning them flush to the wall. Do not over tighten the screws.
4. Double check that the legs are plumb after adhering. It may be necessary to use shims to plumb the surround legs. This should be done immediately before the adhesive sets. If desired, you can space the bottom of the legs  $\frac{1}{4}$ " to create a grout joint.

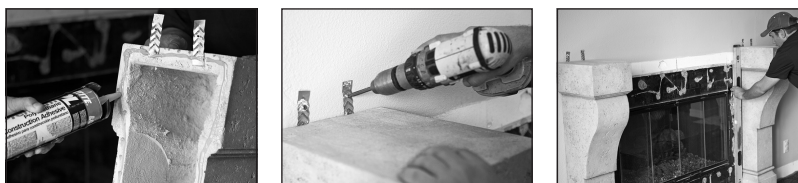
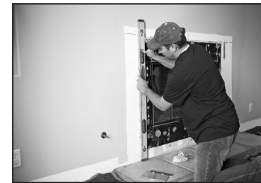

*Step 4***MANTEL INSTALLATION**

The mantel has a small sloped piece along the inside top of the interior of the mantel. This slope is designed to receive the included wood ledger board, which will be mounted on the wall. The wood ledger board holds the mantel in place until the adhesive cures.

1. Lay the mantel face down on your floor and hold the wood ledger board tightly against the receiving slope. Measure the distance from the bottom of the wood ledger board to the bottom of the mantel.

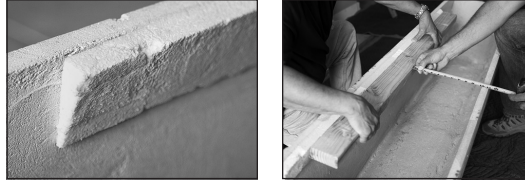

2. Using the dimension referenced above, mark a line on the wall over the fireplace surround legs to indicate the location where the bottom of the wood ledger board will be installed. Add approximately  $\frac{1}{4}$ " for the grout joint between the mantel and the legs.



3. Find the center point for installing the wood ledger board. Using a wood stud finder, mark the location of the studs along the level line for the wood ledger board.
4. Using the 4" screws provided with your surround, attach the wood mantel ledger to the wall along the level line. (NOTE: It is recommended to pre-drill the ledger board where the 4" screws will be located to avoid splitting out the wood.) Ensure that the wood ledger board is level. All screws should be driven securely into structural studs in as many places as possible.



NOTE: Wood Ledger Board receiving slope should slope up away from wall.

5. Determine the midpoint of the mantel and **dry-fit** by setting mantel piece in place on top of ledger board. **Do not use adhesive** until you have double checked the mantel is level and an even grout joint is visible in between each leg. You can use  $\frac{1}{4}$ " spacers to level out the mantel with the legs.



**STEP 4: MANTEL INSTALLATION CONTINUED**

6. Once you have made final adjustments to level the mantel, apply polyurethane adhesive to the back edge of the mantel piece, the top of the wood ledger and the top of the surround legs. Gently press into place over ledger.



7. The top of the mantel includes pre-drilled holes. Use the provided gold trim screws to attach the top of mantel to the ledger board. **Do not over tighten the screws.** Screws should be tightened to the point that the screw head is just below the surface of the mantel. (Fill screw holes with provided color matched caulking or grout.)



8. Finish all joints with provided color matched caulking.

*Step 5***TRIM KIT PANEL INSTALLATION**

If you choose to use the provided trim panels, these will be installed last. Trim panels are optional and are designed to fit the space between the fireplace surround and the firebox. If the surrounding area around your firebox is larger than the provided trim panels, larger sizes are available to order. Other decorative options such as stone and ceramic tile are often used to finalize the installation.

1. Measure the dimensions needed for the trim panels. This will be the distance between the inside leg and the edge of the existing fireplace. Make sure the trim panels do not interfere with the fireplace door and screen opening.
2. Field cut the trim panels to fit with either a 4"-4½" diamond saw or wet tile saw.
3. Apply adhesive to the back of the panel and the wall where the panel will be set. Press the panel against the wall. If trim panels are to be installed over metal, consult a professional for appropriate adhesive. Polyurethane adhesive is not recommended for applying trim material to metal.
4. Grout joints with provided color matched caulking or grout.





SHOWN: *The Palacio™* with oversized trim panels.

## FINALIZING INSTALLATION

To ensure the Eldorado Fireplace Surround is installed properly and maintains as strong a bond to the substrate as possible, adhesives must cure completely. Please follow these recommended guidelines:

- After application, do not disturb product for a minimum of 24 hours.
- Do not allow product application area to come into contact with extreme temperatures. Area must be kept dry while adhesive cures.
- It is essential that **NO** fires be lit in fireplace until after adhesive is completely cured.
- For best results, also caulk or grout joints after adhesive is completely cured.

A color touch-up kit is provided in case the fireplace surround was damaged during installation. If damaged, simply dab a small amount on a rag and apply to blemished area. Wipe excess off.

